

Silicon Etalon 8mm x 8mm

REVISIONS			
REV	REVISED PER	Date	Approved
A	first release	2010 May 7	JHH
B	CN 2132	March 29, 2012	JHH
C	CN 2706	June 17, 2014	JHH

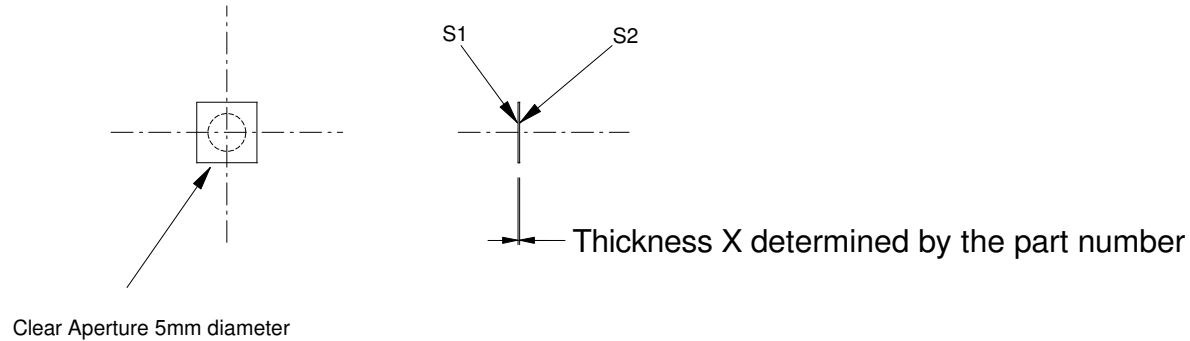

Thickness, A	Tolerance
X	the greater of $\pm 1\%$ of thickness or $\pm 0.002\text{mm}$

Notes:

1. thickness uniformity $\lambda/50$ over CA
2. S1 and S2, scratch dig 10-5
3. Single crystal silicon.
4. Uncoated.

LightMachinery OP-3852-x	
dimensions mm	material Silicon
Scale 1:1	
Tolerances (unless otherwise noted) X ± 0.5 A $\pm 1^\circ$ X.X ± 0.1 A.A $\pm 0.1^\circ$ X.XX ± 0.025	
Drawing Template QT-730-002-C	
This design and print is the property of LightMachinery, Inc., and shall not be used as the basis for the manufacture or sale of apparatus without the written permission of LightMachinery, Inc.	